

D01
1/900
S1 & S2: Typical Bonded Rubber Mulch Safety Surface
SCALE: 1:20 @A0

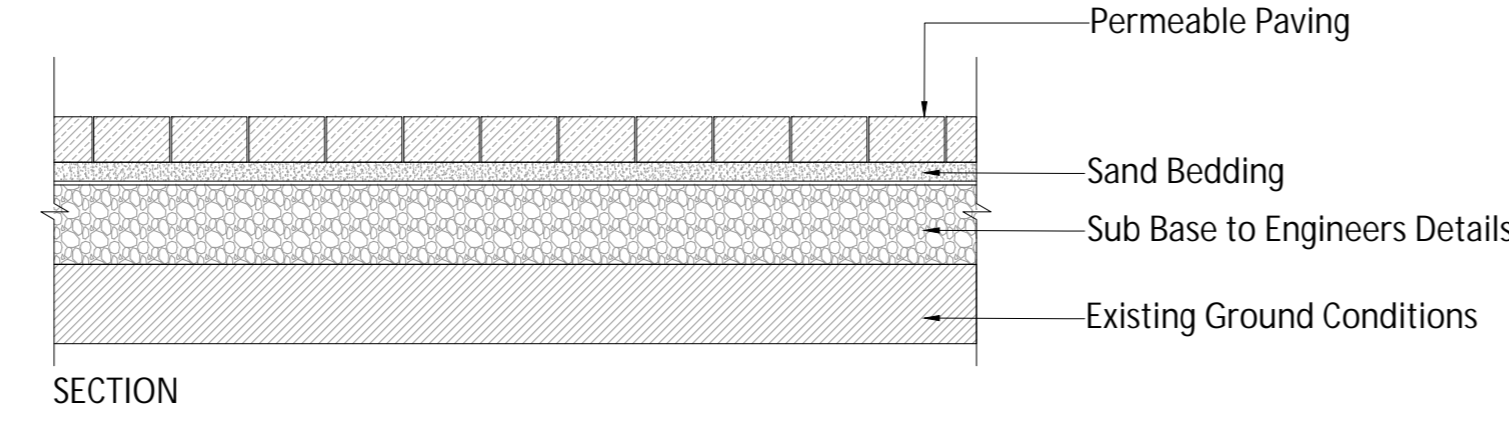

D02
1/900
S3: Typical Permeable Paving Detail to private parking
SCALE: 1:20 @A0

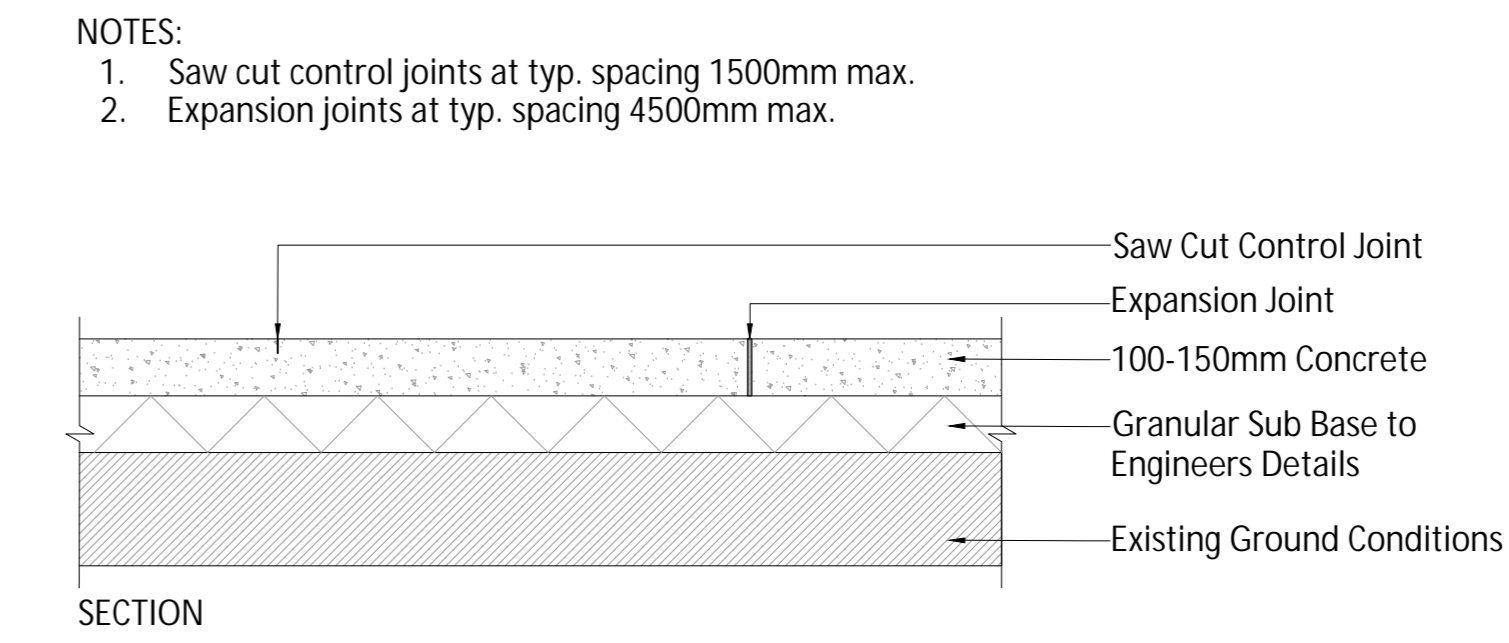
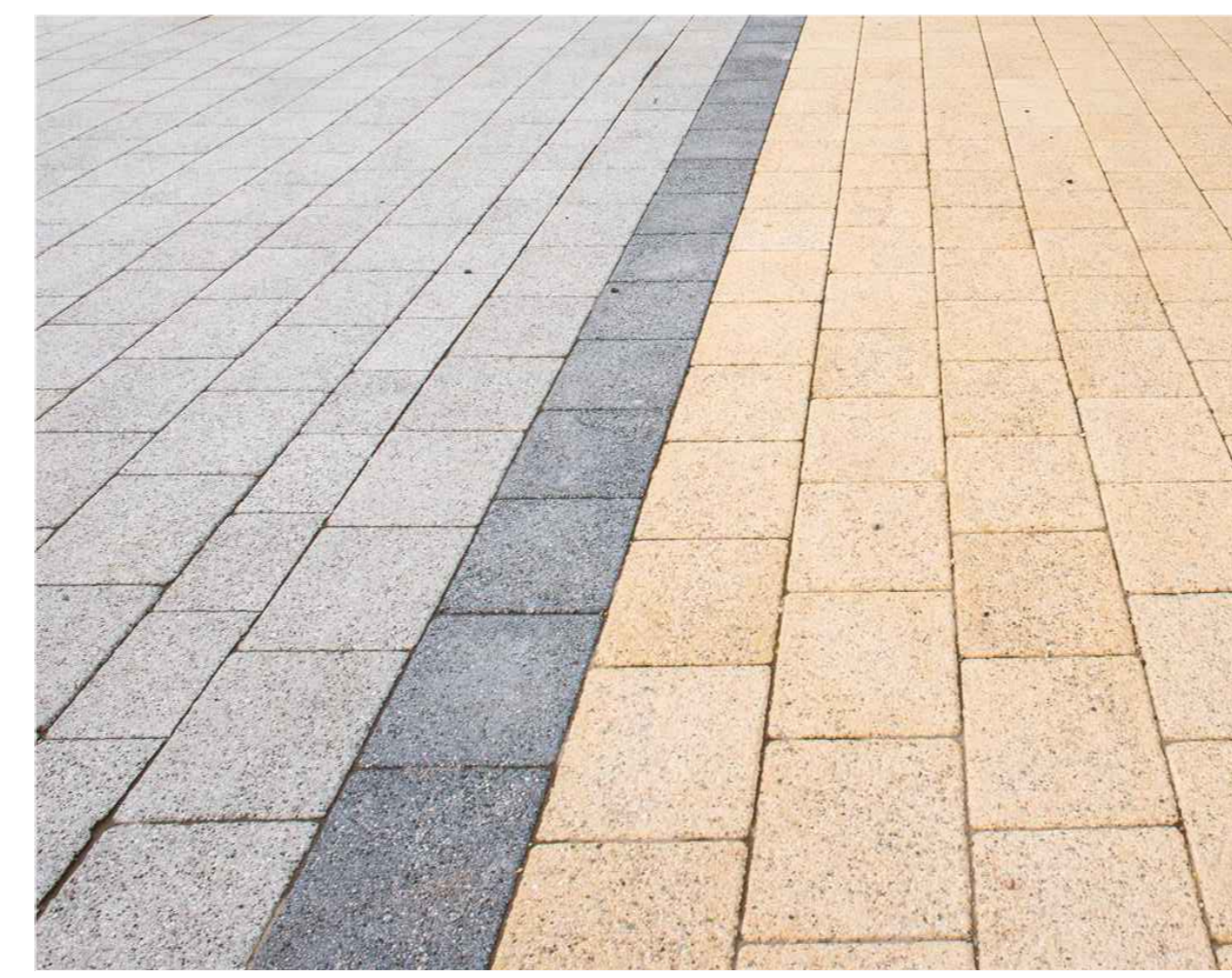

D03
1/900
S4: Typical In-Situ Poured Concrete to private access paths
SCALE: 1:20 @A0

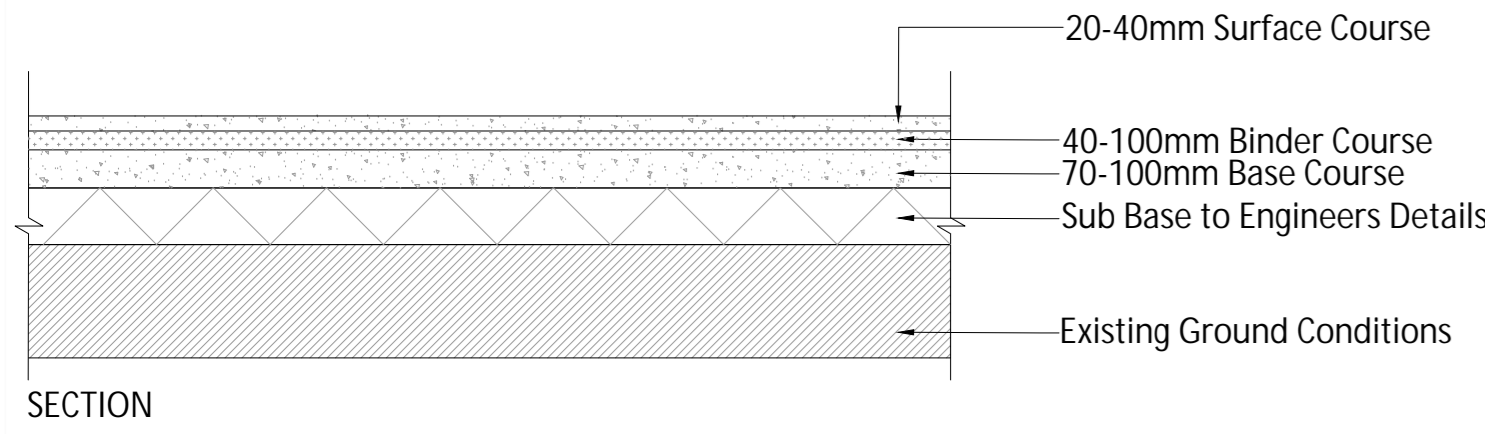

D04
1/900
S5: Typical Buff Tarmac Paving Detail
SCALE: 1:20 @A0

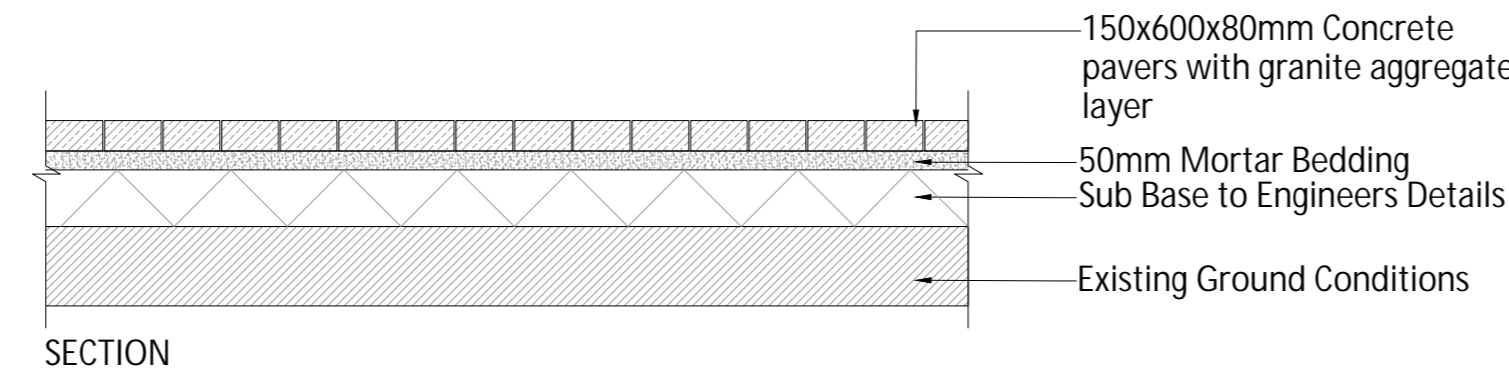

D05
1/900
S6: Typical Feature Paving to Plaza Areas
SCALE: 1:20 @A0

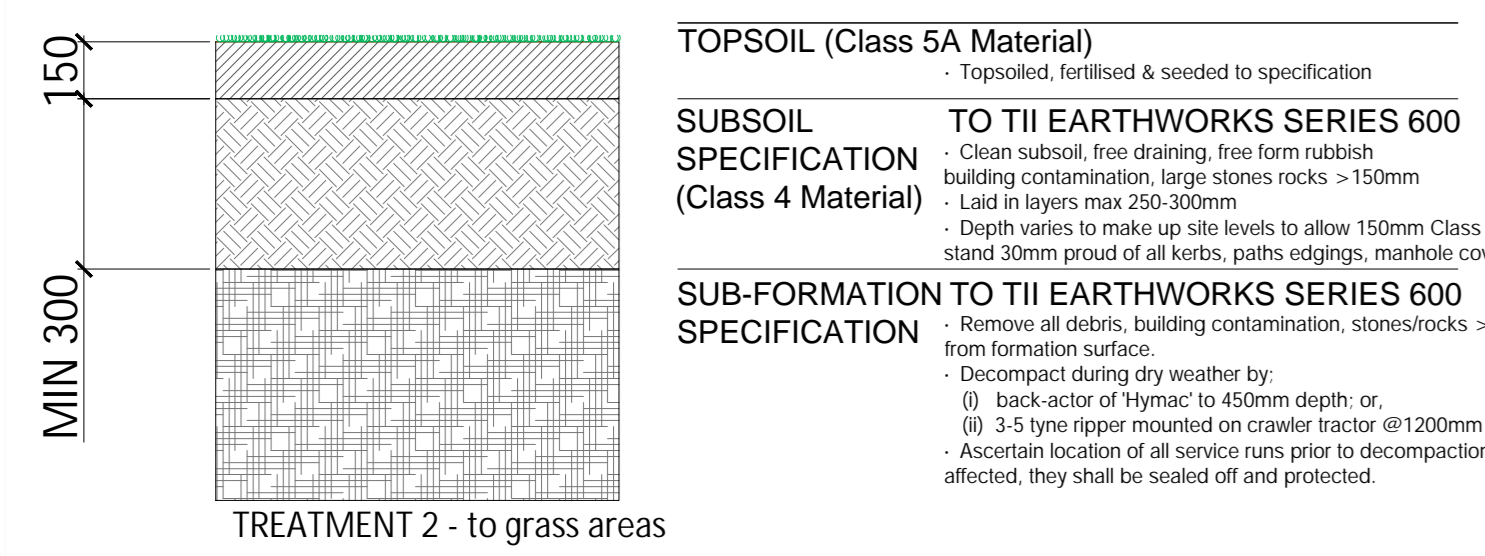
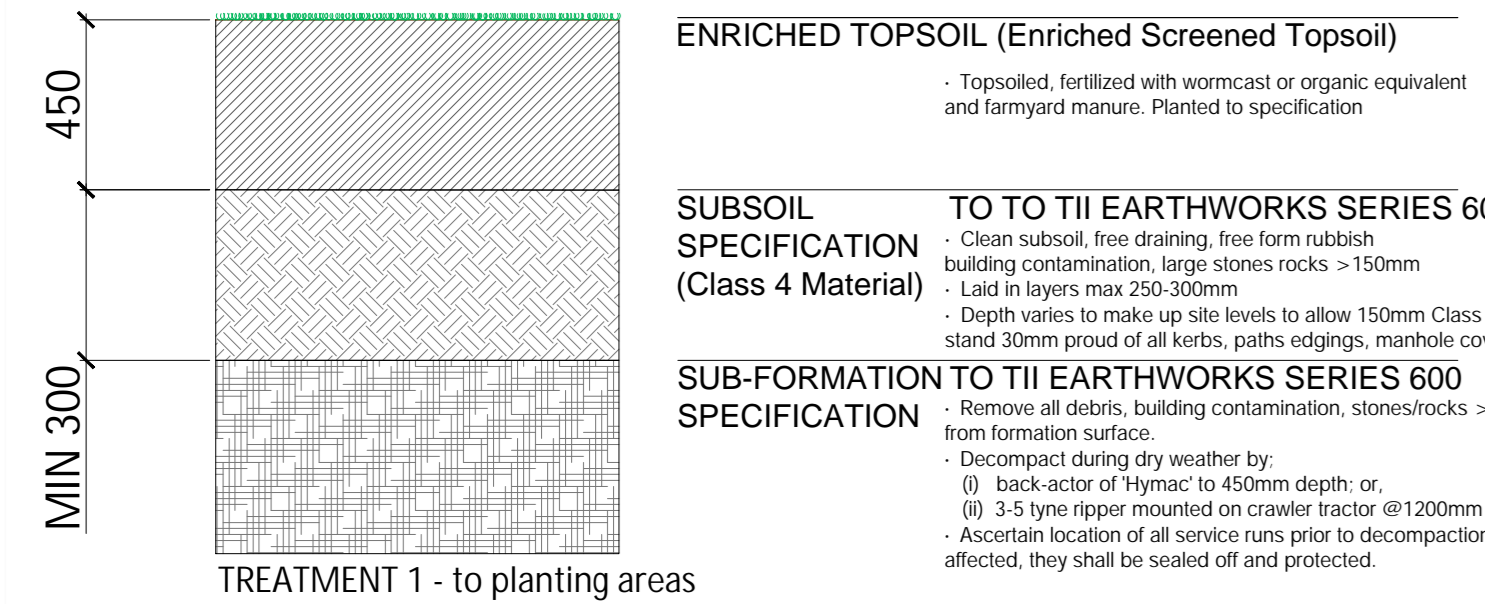

D06
1/900
Typical Planting Details
SCALE: 1:20 @A0

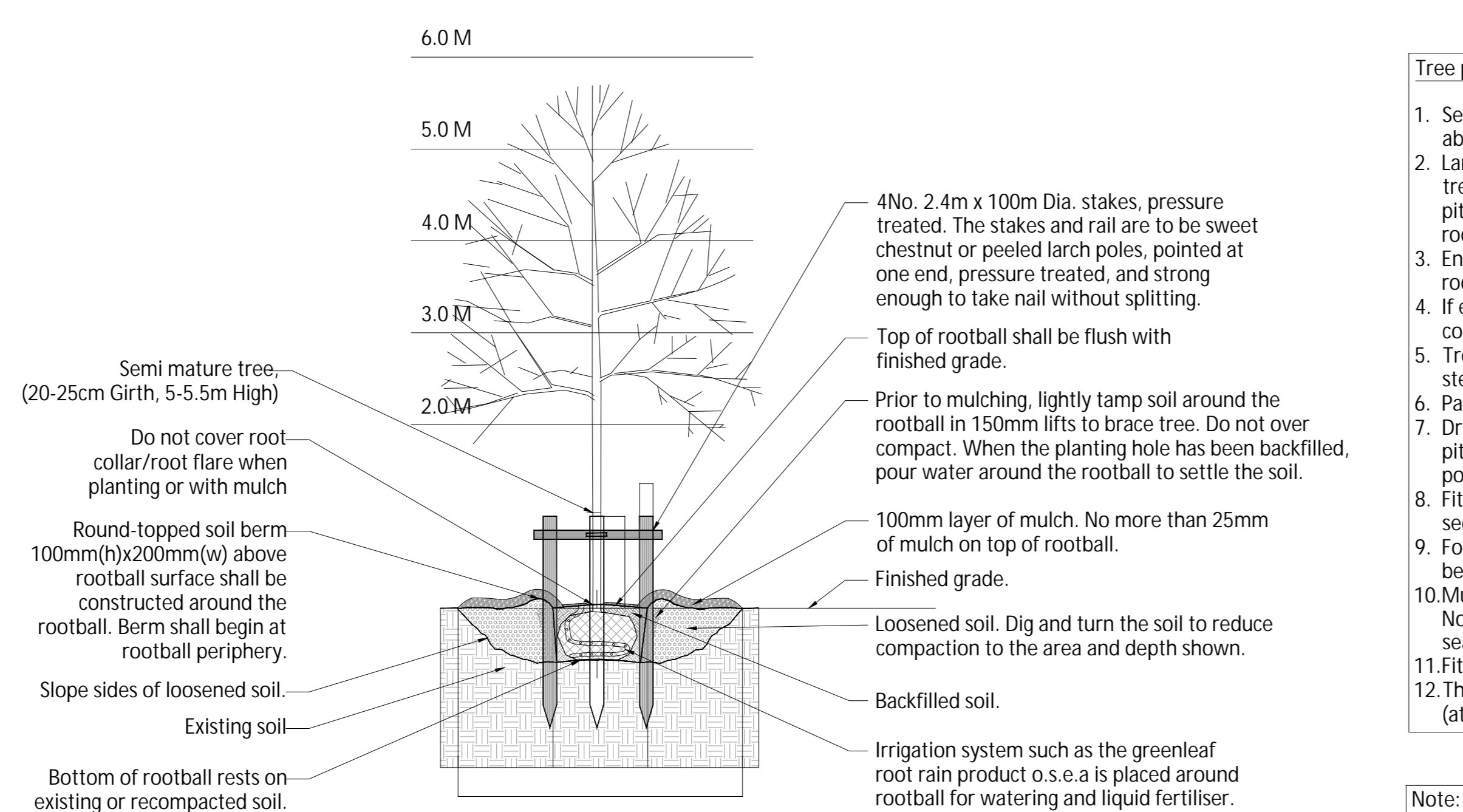

D07
1/900
Typical Tree Planting Detail
SCALE: 1:20 @A0

- Tree planting notes:
- Semi-mature trees shall have a total height of 5.0 to 5.5 metres and a girth of 20-25 cm at 1m above ground level and shall be planted at locations indicated.
 - Larger tree pits should be excavated to minimize the destruction of soils structure. Excavate tree pits to the depth of existing rootball. Base of pit should remain undisturbed. Mound the pit slightly to help shed water away from the upper rootball. Widened tree pit 3 times of the rootball dimension and roughen glazed sides.
 - Ensure an irrigation system such as the greenleaf root rain product o.s.e.a is placed around rootball for watering and liquid fertilizer.
 - If excavated subsoil is particularly heavy-textured soils (silty or clayey), import a high sand content subsoil or even a quarried sand sand to sit the rootball on.
 - Trees are to be planted at the same depth as in nursery (as indicated by the soil mark on the stem of trees) and the soil is carefully firmed back up to existing ground level.
 - Paint stakes and rail in a primer and apply two coats of flat black paint to wood
 - Drive in the 4 stakes so the stakes so they are a minimum of 300mm below the bottom of the pit and 1m above ground level. The stakes and rail are to be sweet chestnut or peeled larch poles, pointed at one end, pressure treated, and strong enough to take nail without splitting.
 - Fit tree tie. Tree ties shall be of rubber, or biodegradable fabric composition and shall be secured to the stake cross rail using galvanized nails.
 - Form round topped soil berm 100mm high and 200mm wide around the rootball. Berm shall begin at root ball periphery.
 - Mulch the base of the tree to a depth of 100mm at a radius of excavated soil around each tree. No more than 25mm of mulch on top of roots. Maintain until spring following the first growing season.
 - Fit rabbit guard.
 - The stakes and rail are to be removed as soon as the tree is anchored securely by its own roots (at the start of the second growing season after planting).

Note:
-The root flare should be clearly visible at the surface of the rootball.
-The soil ball should not move independently of the central stem.

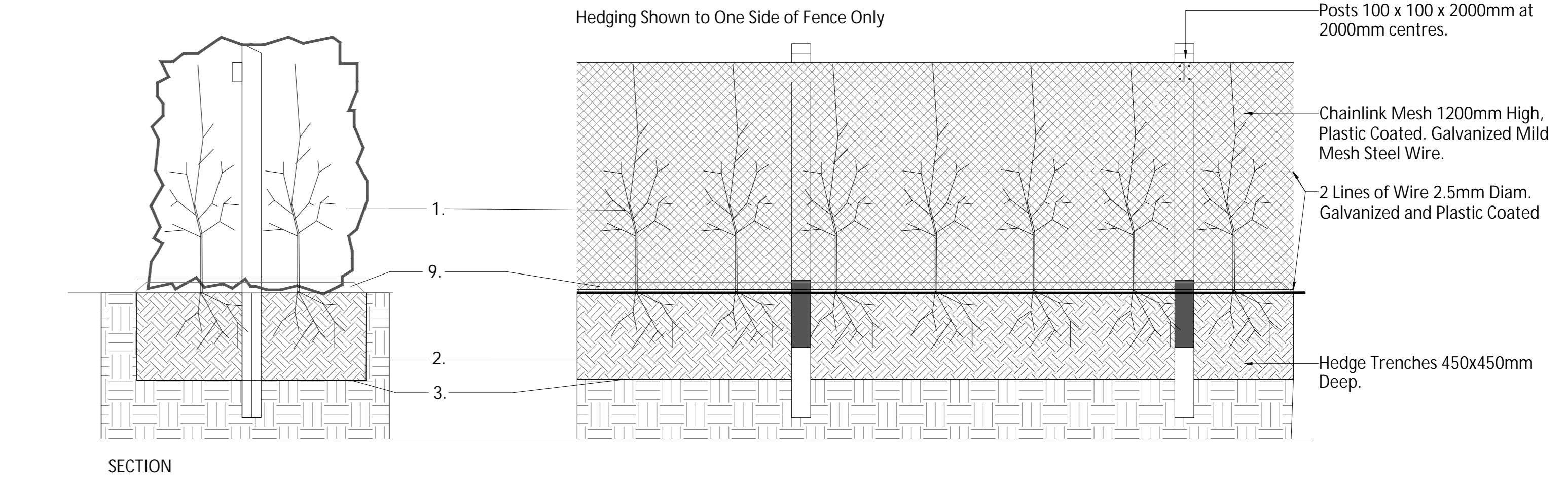

- STAGGERED DOUBLE HEDGE PLANTING WITH FENCE
- Hedgerow transplants height as per drawing planted @ .45 ctrs or otherwise as specified in drawing and in double staggered rows between boundary fences.
 - Excavate a single trench dug approx. 1000 wide x 450mm deep and to the required length.
 - Break up the soil in the base of the trench to 100mm.
 - Mix the stored topsoil on site with enrich compost
 - Prepare the plants by: pruning back any damaged roots to healthy growth; placing roots of waiting plants in water whilst planting; applying an approved mycorrhizal root-dip.
 - Place the plants in the trench in a double staggered row with boundary fence between rows. 450mm between the rows, 450mm between the plants in each row, as shown.
 - Backfill the trench to half its depth and firm by treading. Continue planting the trench.
 - Once planted, backfill with the remaining soil and firm as before.
 - Attach hedging to boundary fence wires with plastic wire ties.
 - Top dress the planting area with 50mm depth of bark mulch.

D08
1/900
Typical hedgerow Planting
SCALE: 1:20 @A0

Rev	Date	Drawn	Checked	Description

Notes	

ORANGE SURVEY LIMITED LICENSE NO. AR 088132
© Orange Survey Ireland/County of Ireland

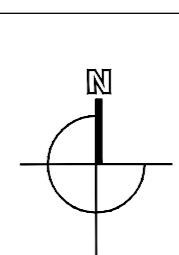

PROJECT: RATOATH MASTERPLAN, CO. MEATH RATOATH RESIDENTIAL DEVELOPMENT	Drawing No: L900	Project No: 6885	Rev: 0
DATE: AS SHOWN @ A0	Scale: Planning	DATE: MAY 2022	
Drawn: AC	Checked: TB		

BSM
Est. 1968